

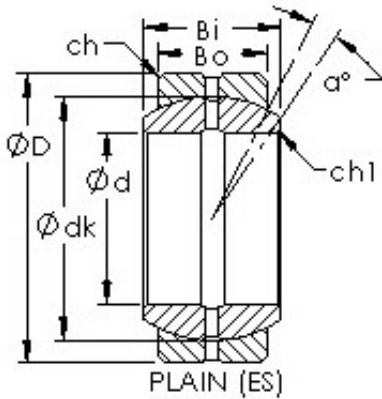

IJK BEARING COMPANY



AST GEZ44ES plain bearings

Bearing No. GEZ44ES

Bore Diameter	44,45 mm
Outer Diameter	71,4375 mm
Bearing Type	plain
Bore Dia (d)	1.7500
Outer Dia (D)	2.8125
Outer Width (Bo)	1.3120
Inner Width (Bi)	1.5310
Dynamic Load Rating (Cr)	38,215
Static Load Rating (Cor)	114,645
Max. shaft corner radius, or 45 deg. chamfer (ch1)	0.024
Max. housing corner radius, or 45 deg. chamfer (ch)	0.040
Spherical Diameter (dk or Dk)	2.516
Mis-alignment Angle (a deg.)	6
Weight (g)	640.00
Material	52100 Chrome steel, or equivalent

GEZ44ES Bearing 2D drawings and 3D CAD models