

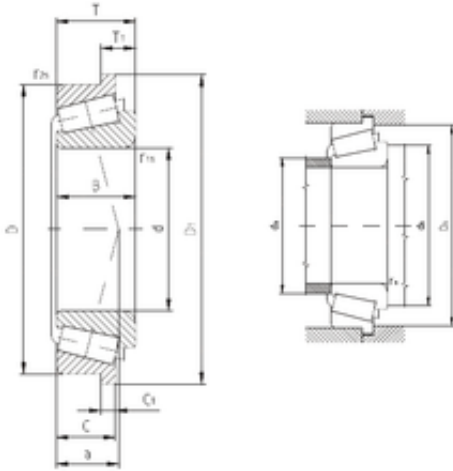

# IJK BEARING COMPANY

## 22 mm x 45 mm x 16,637 mm ZVL K-LM12749/K-LM12712B tapered roller bearings

Bearing No. K-LM12749/K-LM12712B



K-LM12749/K-LM12712B Bearing 2D drawings and 3D CAD models

Size	22x51.5x15.494 mm
Bore Diameter	22 mm
Outer Diameter	51,5 mm
Width	15,494 mm
d	22 mm
D	45 mm
D1	51,5 mm
T	15,494 mm
T1	6,429 mm
B	16,637 mm
C	12,065 mm
r1 min.	1,2 mm
r2 min.	1,2 mm
C1	3 mm
S	5,4 mm
da max	26 mm
db min	27,5 mm
Db min.	46 mm
ra max.	1,2 mm
Weight	0,129 Kg
Basic dynamic load rating (C)	30,2 kN
Basic static load rating (C0)	34,9 kN
(Grease) Lubrication Speed	8 400 r/min
(Oil) Lubrication Speed	11 000 r/min
Calculation factor (e)	0,31



# IJK BEARING COMPANY

Calculation factor (Y)	1,96
------------------------	------